

Controlfix clean out DN 100, Floor slab, tileable

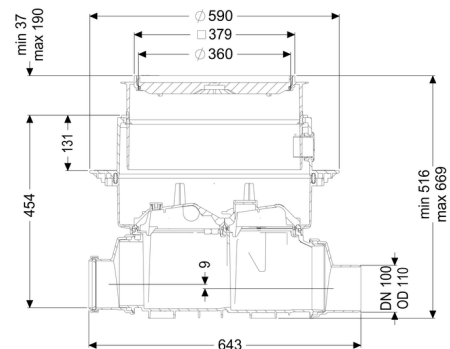

Article information

Item no.: 80100X
 GTIN: 4026092004067
 Price group: 30

Advantages

- Simple conversion to Staufix SWA
- Staufix FKA or Pumpfix F
- Fast
- toolless access for cleaning
- Available as a complete set or module set

Description

The Premium clean out for faecal and faecal-free wastewater makes easy access to wastewater pipes possible for inspection and maintenance work.

Thanks to the modular KESSEL system, existing systems can easily be converted to a Staufix SWA Premium backwater valve, Staufix FKA or Pumpfix F backwater pumping station.

Type of wastewater: wastewater with and without sewage
 Installation situation: floor slab installation

Version:

Type of waterproofing layer: Waterproofing layer

Delivery state: Installation-ready (connection parts must be connected on site)

General characteristics:

Nominal size (DN): 100
 Outer diameter (OD): 110
 Colour: black

Dimensions:

| | |
|---------------------------|--------|
| Length: | 486 mm |
| Width: | 590 mm |
| Cutout dimension, length: | 750 mm |
| Cutout dimension, width: | 750 mm |

Tank:

| | |
|--------------------------------------------------------|--------------|
| Installation depth: | 486 - 640 mm |
| Groundwater resistant from lower edge of base section: | 3,000 mm |

Drain body:

| | |
|----------------------|-------------------------------------|
| Socket version: | including spigot and socket |
| Vertical adjustment: | vertically adjustable upper section |

Coverage features:

| | |
|-----------------------------------------|-------------------------|
| Type of cover: | tileable cover plate |
| Cover material: | Polymer |
| Max. flooring height: | 16 mm |
| Load class: | K 3 (EN 1253-1) |
| Length: | 366 mm |
| Width: | 366 mm |
| Tightness: | surface water resistant |
| Locking: | Lock & Lift |
| Vertical drop between inlet and outlet: | 9 mm |