

Floor drain *The Ultraflat 54*

with standard odour trap

System 125



Made in ABS

Specifications:

With lateral outlet, removable odour trap in the upper section, sealing water height 22 mm and with factory-mounted or non-mounted** waterproofing membrane according to

EN 1253-1 and DIN 18534-1-W3-I.

Drainage capacity in l/sec with 20 mm / 10 mm threshold

Ø 40: 0.8 (*0.9) l/sec / 0.7 l/sec

Ø 50: 0.8 l/sec / 0.6 l/sec.

Installation height 63 – 121 mm.

Installation area 350 × 350 mm

Cover:

Design cover *Kessel* 120 × 120 mm

(anti-slip class R9 according to DIN 51130;

anti-slip class C according to DIN 51097)

and rim made of stainless steel AISI 304

(rim height: 9 mm without *Lock & Lift* locking system, 16 mm with *Lock & Lift* locking system), class L 15 or

slotted cover 120 × 120 mm made of stainless steel AISI 304, rim height 9 mm, class K 3



Illustration shows floor drains with *Lock & Lift* locking system

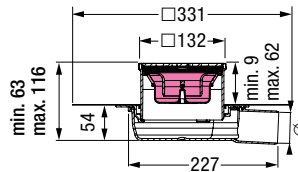

Illustration shows Art. no. 44 740.62M, 44 750.62M, 44 740.20M, 44 750.20M

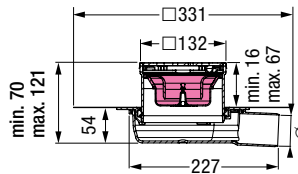

Illustration shows floor drains with *Lock & Lift* locking system

Outer diameter Ø (mm) Art. no.

With design cover, without *Lock & Lift* locking system

Ø 40	44 740.62M
Ø 50	44 750.62M
Ø 40**	44 740.62
Ø 50**	44 750.62

With slotted cover, without *Lock & Lift* locking system

Ø 40	44 740.20M
Ø 50	44 750.20M
Ø 40**	44 740.20
Ø 50**	44 750.20

With design cover, with *Lock & Lift* locking system

Ø 40*	44 740.63M
Ø 50	44 750.63M
Ø 40**	44 740.63
Ø 50**	44 750.63

*drainage capacity Ø 40: 0.9 l/sec with 20 mm threshold

**with non-mounted waterproofing membrane

Floor drain *The Ultraflat 54*

with mechanical odour trap *Megastop*

System 125



Made in ABS

Specifications:

With lateral outlet, mechanical odour trap

Megastop in the upper section, hair filter,

backwater-proof up to 0.1 bar and

with factory-mounted waterproofing

membrane according to EN 1253-1 and

DIN 18534-1-W3-I.

Drainage capacity in l/sec with 20 mm / 10 mm threshold

Ø 40: 0.7 l/sec / 0.6 l/sec

Ø 50: 0.6 l/sec / 0.55 l/sec.

Installation height 70 – 121 mm.

Installation area 350 × 350 mm

Installation area 350 × 350 mm

Cover:

Design cover *Kessel* 120 × 120 mm

(anti-slip class R9 according to DIN 51130;

anti-slip class C according to DIN 51097)

and rim made of stainless steel AISI 304

(rim height: 16 mm), class L 15,

with *Lock & Lift* locking system

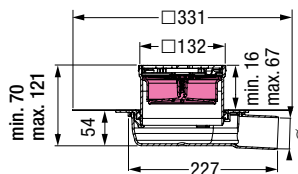

Outer diameter Ø (mm) Art. no.

Ø 40	44 740.66M
Ø 50	44 750.66M