

### Parking deck drain *Ecoguss*

with pressure sealing flange in stainless steel AISI 304

System 125



Made in *Ecoguss Heavy Duty*. Vertical outlet, for connection to SML-pipe according to EN 877, with sludge trap.

Drainage capacity 4.5 l/sec flow rate.

Installation area 300×300 mm

With pressure sealing flange in stainless steel AISI 304, with square upper section in *Ecoguss Heavy Duty* with connection flange 247×247 mm

**Cover:**

Round slotted cover Ø 234 mm, class B 125 (12.5 to), with *Lock & Lift System*

**Note:**

Core drilling only Ø 160 mm with *Quick-Fit*

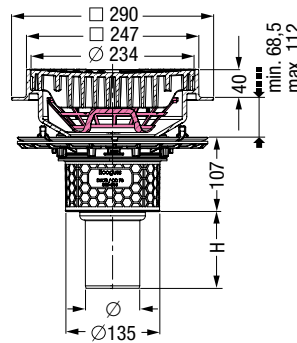

Outer diameter Ø (mm)	Height H in mm	Height H1 in mm	Art. no.
System 125			
Ø 78	110	-	<b>48 878.01</b>
Ø 110	110	-	<b>48 811.01</b>

### Parking deck drain *Ecoguss*

square or round

System 100

System 125

Made in *Ecoguss Heavy Duty*. Vertical outlet, for connection to SML-pipe according to EN 877, with sludge trap.

Drainage capacity 4.5 l/sec flow rate.

Installation area 300×300 mm

With square (247×247 mm) or round (Ø 247 mm) upper section in *Ecoguss Heavy Duty* with connection flange

in *Ecoguss Heavy Duty* with connection flange

**Cover:**

Round slotted cover Ø 234 mm, class B 125 (12.5 to), with *Lock & Lift System*

**Note:**

Can be used as single piece pipe connection drain!



Illustration shows Art. no. 48 502

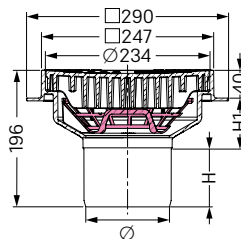

Illustration shows Art. no. 48 501, 48 502

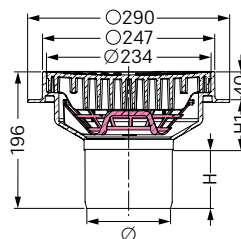

Illustration shows Art. no. 48 503, 48 504

Outer diameter Ø (mm)	Height H in mm	Height H1 in mm	Art. no.
System 100 (SML-pipe) with square upper section			
Ø 110	77	79	<b>48 501</b>
System 125 (plastic pipe) with square upper section			
Ø 125	83	73	<b>48 502</b>
System 100 (SML-pipe) with round upper section			
Ø 110	77	79	<b>48 503</b>
System 125 (plastic pipe) with round upper section			
Ø 125	83	73	<b>48 504</b>